

**TOWNSHIP ADOPTION**

APPROVED AND ADOPTED BY THE GUILFORD TOWNSHIP BOARD OF SUPERVISORS THIS 15th DAY OF July 2010.

SUPERVISOR *[Signature]* 7-15-10  
 DATE  
 SUPERVISOR *[Signature]* 7-15-10  
 DATE  
 SUPERVISOR *[Signature]* 7-15-10  
 DATE

# OFFICIAL MAP GUILFORD TOWNSHIP FRANKLIN COUNTY, PENNSYLVANIA

NOTE:  
 TOWNSHIP ROUTE NUMBERS REVISED APRIL 1, 1986 AS PER THE PENNSYLVANIA DEPARTMENT OF TRANSPORTATION, BUREAU OF MUNICIPAL SERVICES SURVEY. (DATE OF SURVEY: FALL 1985)

BASE MAP COMPILED IN COMPUTERIZED DIGITAL FORMAT: APRIL 1996

THE ORIGINAL GUILFORD TOWNSHIP ROAD MAP WAS PREPARED BY THOMAS MICHAEL ENGLERTH SURVEYING DATED 3/25/1996.

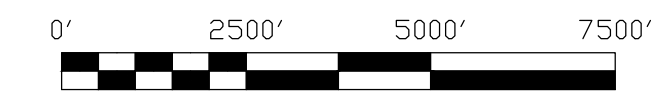

**LEGEND**

- EXISTING INTERSTATE ROAD
- EXISTING STATE ROAD
- EXISTING TOWNSHIP ROAD
- FUTURE ROAD
- FUTURE TRAFFIC SIGNAL
- APPALACHIAN TRAIL
- RECREATIONAL AREA
- FUTURE SANITARY SEWER
- FUTURE WATER MAIN
- FUTURE RAILROAD CROSSING CLOSURE
- ADDITIONAL DEDICATED RIGHT-OF-WAY

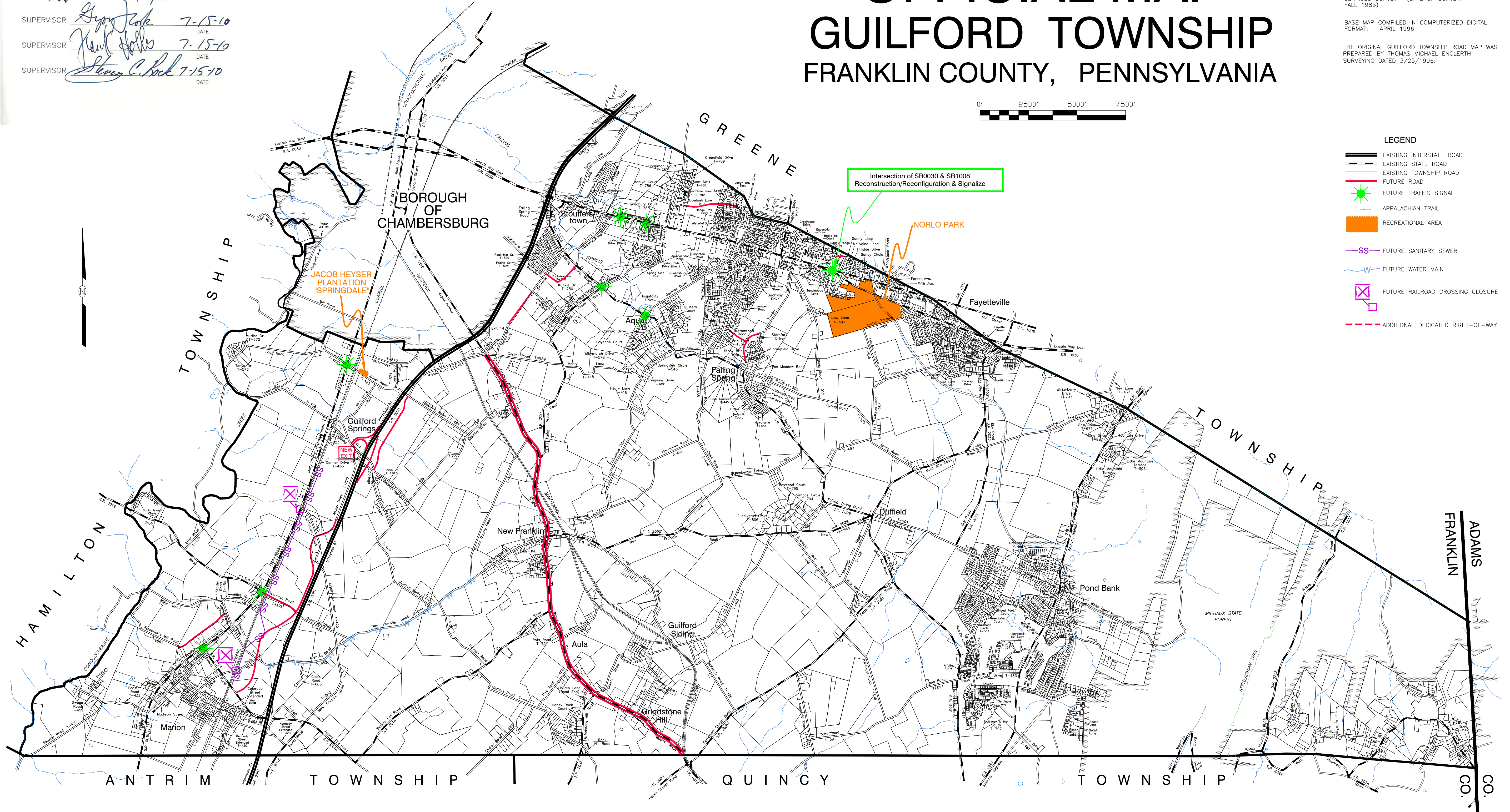

Intersection of SR0030 & SR1006  
 Reconstruction/Reconfiguration & Signalize

NORLO PARK

- Plan Notes:**
- The actual location of the Appalachian Trail, based upon field survey, is on lands of the United States of America and not currently subject to Guilford Township Zoning regulations.
  - The depiction of future sewerage service to Swamp Fox Road (S.R. 0914) north of the village of Marion is conceptual in scope and not intended to serve as a precise alignment or design of such system. Reference is made to the Guilford Township Act 537 Sewage Facilities Plan dated December 2000, in which depiction on the official map of future sewer lines serving the Industrial District between US Route 11 and Interstate 81 South of Chambersburg, was approved by D.E.P. as a non-structural policy of the Board of Supervisors.
  - The new exit of Interstate 81 and Guilford Springs Road as depicted hereon is conceptual in scope and subject to the need, design and construction as ultimately determined by the Pennsylvania Department of Transportation. Reference is made to the I-81 Feasibility Study and Conceptual Point of Access dated July 2009.
  - The location of the future Roads shown hereon does not necessarily reflect the exact location in the field. Final location is subject to design and construction needs as approved by Guilford Township.
  - The improvements to Wayne Road (S.R. 0316) include right-of-way acquisition (generally ten (10) additional feet) for widening, intersection improvements including turning lanes and realignments as well as shoulder improvements as outlined in the Franklin County Comprehensive Plan, Transportation Plan, June 1999.
  - The railroad crossing closure proposed on Lighthouse Road (T-425) shall occur only after completion of the Archer Drive (T-820) connection to Lighthouse Road.
  - The railroad crossing closure proposed on Third Street (T-559) shall occur only after completion of the connector road from Allemen Road (T-452) to Swamp Fox Road (S.R. 0914).
  - The intersection and signalization improvements shown at the Overcash Road/Social Island Road/U.S. Route 11 intersection as proposed by the Greater Chambersburg, Southwest Corridor Study, Transportation Planning Report dated December 2006.
  - The intersection and signalization improvements shown at the Kriner Road/Loop Road/U.S. Route 11 intersection are currently (November 2009) under construction.

REVISION RECORD		
DATE	REVISION	RECORDED
11/24/1998	ADD RECREATION AREA	VOL. 2886 PG. 1025 PART II
07/15/2010	COMPLETE AMENDMENT	Instrument #201013791